

ESQUE®

**Models/Modelos/Modèles
9181T-DST & 9981T-DST**

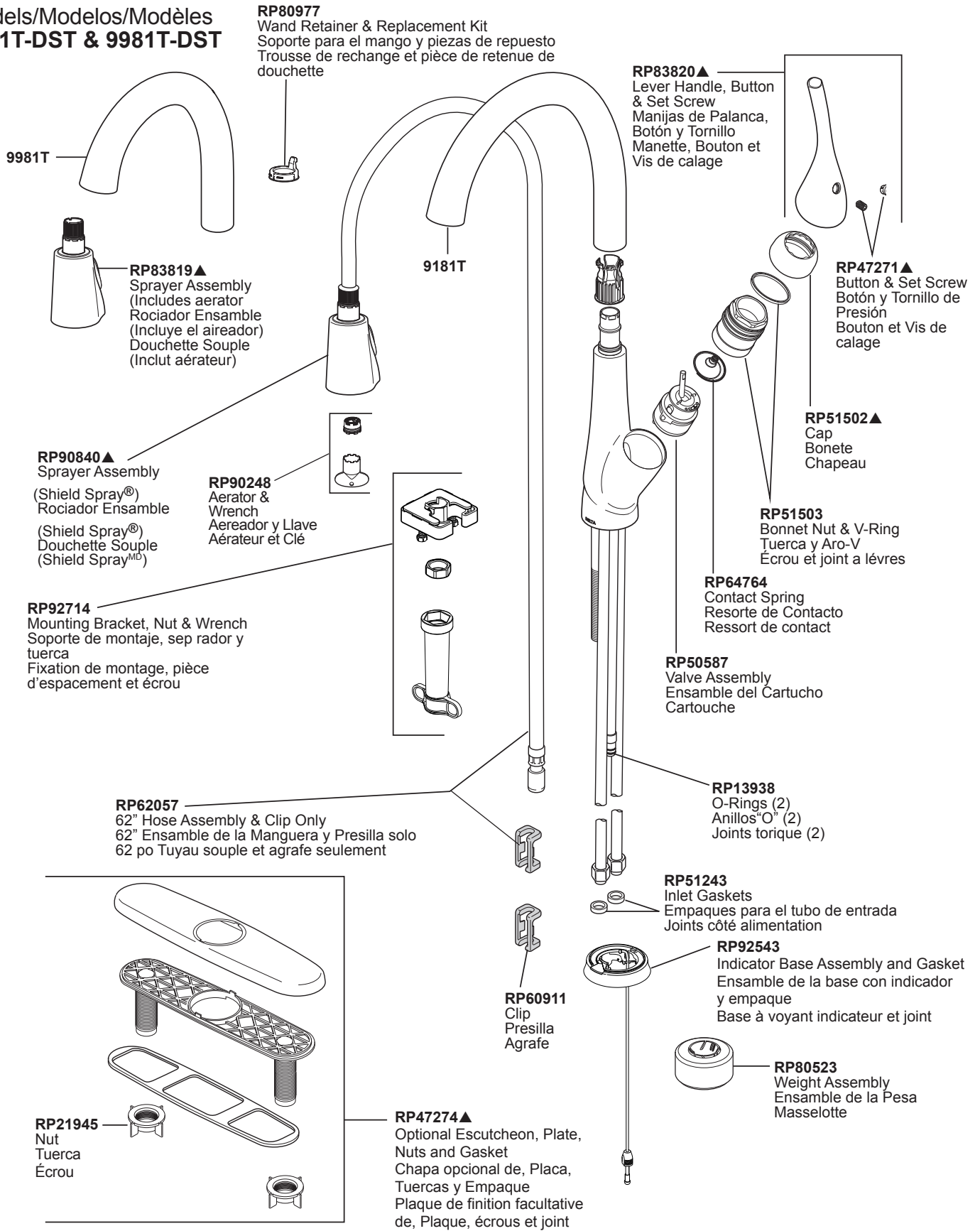

▲Specify Finish / Especificque el Acabado / Précisez le Fini

EP92546
Solenoid Assembly
Ensamble de Solenoide
Électrovanne

For PC, CZ, & AR finishes, order **EP92546**
For RB finishes, order **EP92546XX**

Para acabados PC, CZ, y AR, ordene **EP92546**
Para acabados RB, ordene **EP92546XX**

Pour les finis PC, CZ et AR, commandez **EP92546**
Pour les finis RB, commandez **EP92546XX**

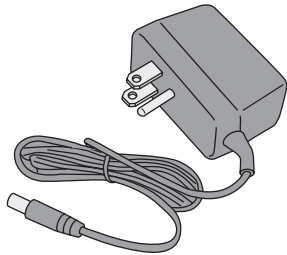

EP73954
9 Volt Power Supply
(Accessory Order Only)
Fuente de alimentación de 9 voltios
(Orden de accesorios solamente)
Alimentation électrique 9 volts
(L'accessoire seulement)

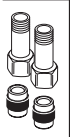

RP53468
Check Valves
Válvulas Checadoras
Clapets de non-retour



RP50952
Cut -To - Fit Plastic Sleeves
Mangas plásticas para cortar a la medida
Manchons de plastique sectionnés

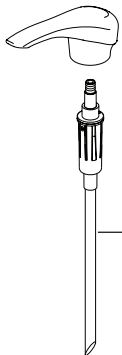

RP83779
Pump
Bomba
Pompe

RP100737▲
Dispenser Assembly
Ensamble del Dispensador
Distributeur

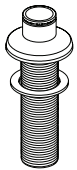

RP78489
Nut
Tuerca
Écrou



RP78490
Bottle
Bottella
Bouteille



RP93410
Filter
Filtro
Filtre

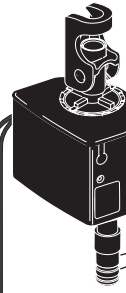

RP13938
O-Ring (2)
Anillo "O" (2)
Joint torique (2)

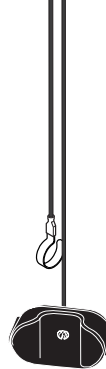

RP60911
Clip
Presilla
Agrafe



RP78389
Battery Box
Caja de la Batería
Boîtier de piles

Other useful accessories that may be purchased separately.
Otros accesorios útiles que se pueden comprar por separado.
Autres accessoires utiles pouvant être achetés séparément.

RP63263

Adapters
3/8"-24 UNEF to 1/2"-20 UN &
3/8"-24 UNEF to 1/2"-14 NPSM

Adaptadors
3/8"-24 UNEF a 1/2"-20 UN &
3/8"-24 UNEF a 1/2"-14 NPSM

Adaptateurs
3/8 po-24 UNEF à 1/2 po-20 UN et
3/8 po-24 UNEF à 1/2 po-14 NPSM

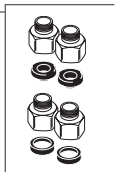

RP63264

Adapters (10) 3/8"-24 UNEF to 1/2"-20 UN
Adaptadors (10) 3/8"-24 UNEF a 1/2"-20 UN
Adaptateurs (10) 3/8 po-24 UNEF à 1/2 po-20 UN



RP63265

Adapters (10) 3/8"-24 UNEF to 1/2"-14 NPSM
Adaptadors (10) 3/8"-24 UNEF a 1/2"-14 NPSM
Adaptateurs (10) 3/8 po-24 UNEF à 1/2 po-14 NPSM



▲ Specify Finish / Especificque el Acabado / Précisez le Fini