

591T Series – Electronic Faucet Trim For Recess Mounted Control Box

TECK[®]
COMMERCIAL

DELTA[®]

SPECIFICATION: (EXAMPLE)

591T1258TR



- Supplied as trim parts only – requires separate order of ELAVT0001ARI* or ELAVT0008ARI* rough-in to have complete product
- H₂O_{PTICS}[®] technology – no external adjustments required
- Trim includes 12" stainless steel cover, driver board, solenoid
- Chrome-plated **CAST** 102 mm (4") spout body with integral sensor
- Adjustable sensing range and timeout
- **Battery** (4 "C" cell) or **Hardwire** (24VAC) infrared electronic handwash
- Serviceable filter screen upstream of the solenoid valve
- Metal hold-down package
- and... with... (specify battery or hardwire)
- with... (add outlet required)
- with... (for hardwire with battery backup – specify separately – see next page)
- with... (transformer for hardwire operation – specify separately – see next page)

Engineer/Architect Approval

Model Specified:

Approval:

Date:

MODEL NUMBER EXAMPLE:

Configurations vary, see below for availability.

591T0228TR

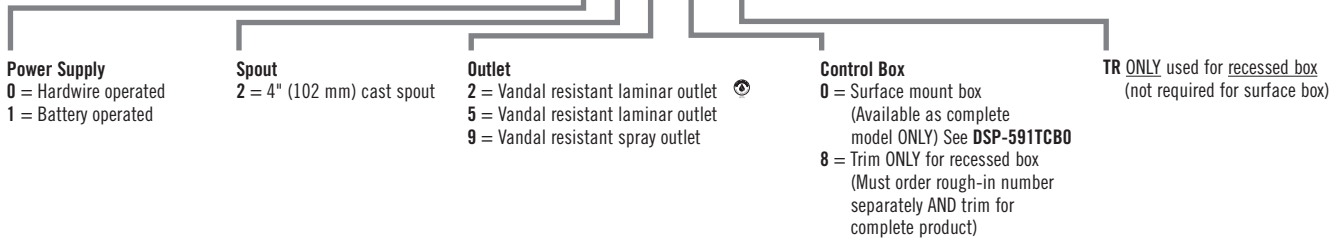

AVAILABLE MODELS	RECESS MOUNTED CONTROL BOX	
	HARDWIRE	BATTERY OPERATED
2 Deckmount 4" Spout		2 Deckmount 4" Spout
2 Vandal Resistant Laminar Outlet 1.5 gpm (5.7 L/min)	591T0228TR	591T1228TR
5 Vandal Resistant Laminar Outlet 0.5 gpm (1.9 L/min)	591T0258TR	591T1258TR
9 Vandal Resistant Spray Outlet 0.35 gpm (1.32 L/min)	591T0298TR	591T1298TR

*ELAVT0001ARI – no mixing valve or ELAVT0008ARI with thermostatic mixing valve – specify separately.
Refer to www.specselect.com for individual models.
Batteries included on all battery models.

Flow Rates are at 60 PSI.
Note: Use these pages as product submittal sheets.



Delta reserves the right (1) to make changes in specifications and materials, and (2) to change or discontinue models, both without notice or obligation.
Dimensions are for reference only. See current full-line price book or www.specselect.com for finish options and product availability.

591T Series – Electronic Faucet Trim For Recess Mounted Control Box

TECK
COMMERCIAL

DELTA

APPROVALS:

- CSA certified
- Complies to ASME A112.18.1/CSA B125.1
-  Indicates compliance to ICC/ANSI A117.1
-  Outlet option 2 is EPA WaterSense listed
- Verified compliant with 0.25% weighted average Pb content regulations

(Contact Delta Representative for State and/or Local Approvals.)

Patented

FLOW RATE VS PRESSURE

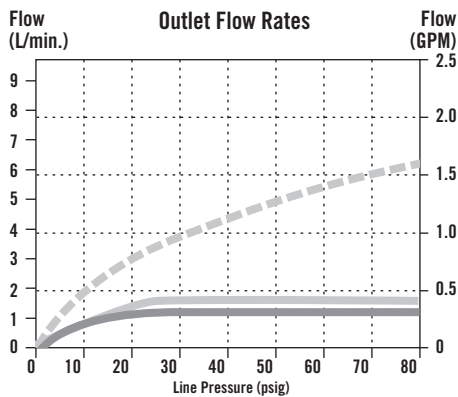

FRONT VIEW

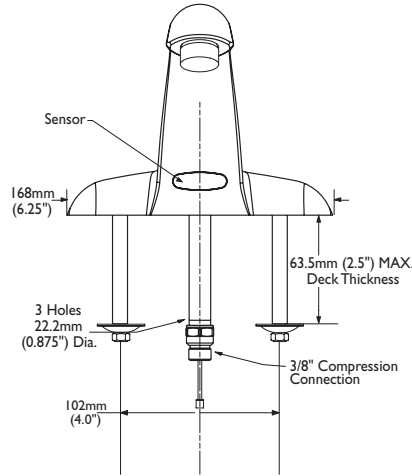

SIDE VIEW

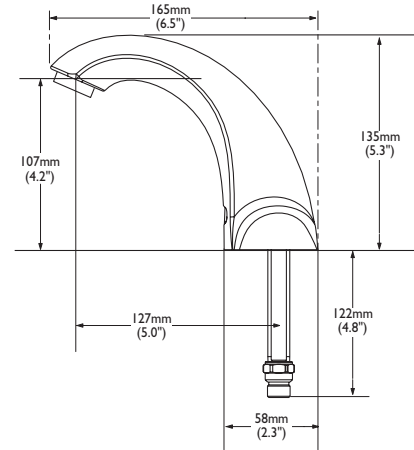

TYPICAL INSTALLATION

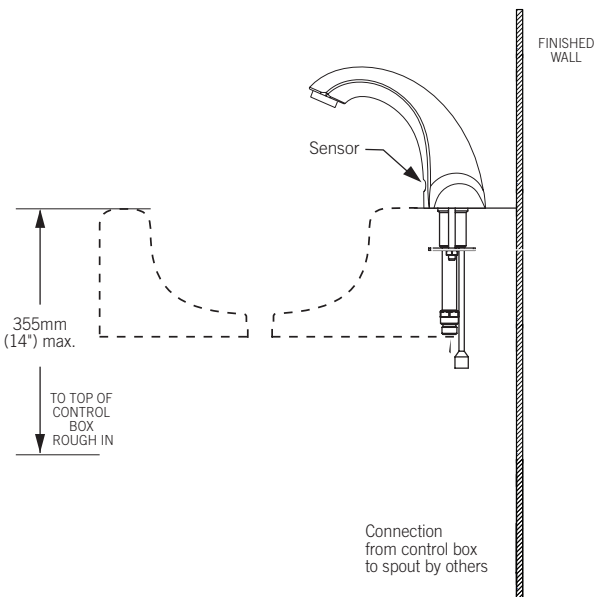

AVAILABLE OPTIONS FOR FIELD CONVERSION

- 061047A**
Hardwire with Battery Backup
See DSP-BB for detailed specification.
- 060651A**
3 Position Switch
See DSP-ELACC for detailed specification.

Note: Measurements may vary ± 6mm (0.25")

Refer to www.specselect.com for individual models.
Product supplied as shown by solid lines. All items shown by dotted lines supplied by others.

DSP-591TCB8 Rev. F

Delta reserves the right (1) to make changes in specifications and materials, and (2) to change or discontinue models, both without notice or obligation. Dimensions are for reference only. See current full-line price book or www.specselect.com for finish options and product availability.

591T Series – Electronic Faucet Trim For Recess Mounted Control Box

TECK[®]
COMMERCIAL

DELTA

SENSOR CLEARANCE

For above deck mounted sinks,
the sensor requires a clearance.

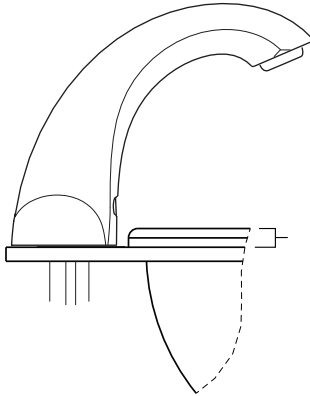

For sensor clearance:
10 mm (0.4") maximum sink
lip height from deck

OPERATION:

- Hands free (touchless) operation.
- Water flows when sensor is activated.
- Water flow stops upon de-activation of sensor.
- Adjustable auto shut-off feature. Factory set to 45 seconds. Will reset once obstruction is removed.
- Adjustable sensing distance 76 to 381mm (3" to 15") factory set to 229mm (9") (± 3.0")
- Low battery audible beep (for battery models only) will activate after faucet shuts off when approximately 1500 cycles remain.
- Metering mode with selectable flow times of 7 seconds to 4 minutes, factory set off.
- Periodic Rinse feature, time adjustable in 6 hour increments up to 2 days. Selectable rinsing lengths from 10 to 180 seconds. Factory set off.

NOTE 1: For optimum performance of this product, we recommend a system pressure between 20 and 80 PSI static. This product will operate up to a maximum of 125 PSI static per ANSI and CSA requirements. However, we do not recommend pressures above 80 PSI. Thermal expansion or leaking pressure reducing valves may require use of expansion tanks or relief valves to ensure your system never exceeds its maximum intended pressure setting.

NOTE 2: Trim used with ELAVT0001ARI designed for routine 171°F (77°C) disinfection cycles up to 30 minutes. Trim used with ELAVT0008ARI is not recommended for high temperature disinfection cycles as the thermostatic mixing valve limits the higher temperature flow outlet.

OPTIONAL ACCESSORIES

✓	TRANSFORMERS
	060704A 110 to 24 VAC Class 2 20 VA (Up to 5 Electronic Valves)
	060771A 110 to 24 VAC Class 2 40 VA (Up to 10 Electronic Valves)
✓	CORDS
	061256A 36" Cable Extension

Note: Measurements may vary ± 6mm (0.25")

Refer to www.specselect.com for individual models.
Product supplied as shown by solid lines. All items shown by dotted lines supplied by others.

Delta reserves the right (1) to make changes in specifications and materials, and (2) to change or discontinue models, both without notice or obligation. Dimensions are for reference only. See current full-line price book or www.specselect.com for finish options and product availability.

DSP-591TCB8 Rev. F